

# FABRICATED TEE STRAINERS

**2" - 30" | ANSI CLASS 150**



Fabricated Tee Strainers are required when an off-the-shelf solution will not meet your exact piping requirements. All of our Fabricated Strainers are made right here in the USA, at our state-of-the-art facility in the southeastern part of North Carolina.

**6" Fabricated Tee Strainer, ANSI 150, with Quick Open Cover Shown**

All pictures shown are for illustrative purposes only. Actual product may vary due to product enhancement.

**Sizes 2" - 30" Available**

## MODEL

**FT 20 Series - 150 Class**

## MATERIALS:

- Carbon Steel • Stainless Steel
- Other Alloys

## OPTIONS



- Gauge Taps
- Vent - (Standard)
- Drains
- Back Flush Valves
- Semi-Automatic
- Pressure Gauges
- DP Gauge Switch

## CUSTOM COVER SOLUTIONS INCLUDING DAVITS & HINGED COVER



**HINGED**



**DAVIT**



**BOLTED**



### ANSI CLASSES

ANSI Class 150 up to high pressure 900 class



### STRAINING ELEMENTS

Customize to fit your requirements  
Heavy Duty Baskets



### END CONNECTIONS

Flanged, Raised Face, RTJ, Butt Weld, Socket Weld, Threaded



### SANITARY

Sanitary Application Designs for food/pharmaceutical processing



### TEMPERATURE CONTROL

Steam Jacket casing for set temperature control



### UNIQUE PROJECTS

Rotated and Offset Nozzles to fit into your applications



290 Corporate Dr  
www.titanfci.com  
Phone: 910.735.0000

Lumberton, NC 28358  
titan@titanfci.com  
Fax: 910.738.3848

2" - 30"

FT 20 Series  
Tee Strainer

ANSI Class  
150

**BILL OF MATERIALS**<sup>(1)</sup>  
FT 20 Series

Part	FT 20 - 25 CS	FT 20 - 25 SS
1 Body	Carbon Steel A234 Gr.WPB	Stainless Steel SA403
2 Cover	Carbon Steel A105	Stainless Steel SA182 Type 316
3 Quick Open Cover Assembly	Carbon Steel A516 Gr.70	Stainless Steel Type 316
4 Cover Gasket/ O-Ring <sup>(2)</sup>	<b>Bolted:</b> Spiral Wound Stainless Steel	<b>Quick Open:</b> Buna-N <sup>(3)</sup>
5 Straining Element <sup>(2)(4) (5)</sup>	T304 SS	T304 SS
6 Inlet/Outlet Flange	Carbon Steel A105	Stainless Steel SA182 Type 316
7 Weld Neck Flange	Carbon Steel A105	Stainless Steel SA182 Type 316
8 Bolts	Carbon Steel A193-B7	Stainless Steel A193 B8 M
9 Nuts	Carbon Steel A194 2H	Stainless Steel A194 Gr.8
10 T-Bolt	Carbon Steel A325	Stainless Steel
11 Vent with Plug <sup>(6)</sup>	Carbon Steel A105	Stainless Steel SA182 Type 316

1. Bill of Materials represents standard materials. Equivalent or better materials may be substituted at the manufacturer's discretion.
2. Titan recommends keeping spare parts on hand.
3. Buna-N is standard for applications below 250° F. Viton is standard for applications above 250° F.
4. Max mesh size available is 60 mesh.
5. 1/8" perf is standard for all mesh lined straining elements.
6. 1/2" NPT is standard

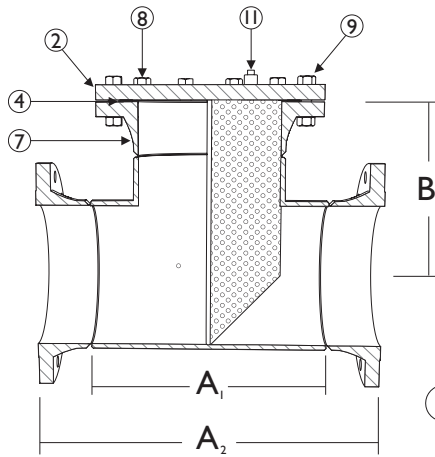

Model FT 21

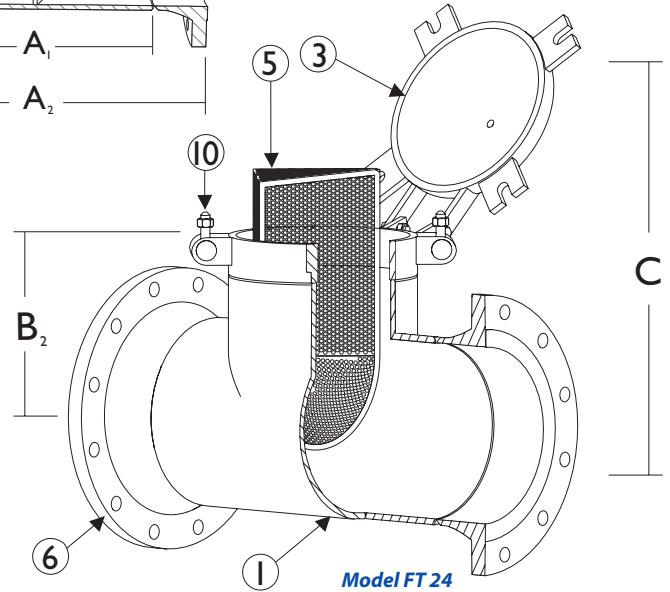

Model FT 24

Illustrations are representative of Titan FCI fabricated tee strainers; however, as with all fabricated designs, actual products may vary. **Certified drawings are required for all Titan fabrications.**

**Tee Strainers are not recommended for suction applications.**

**Optional bottom drains (2" NPT Standard) are available at extra cost.**

**FT 20 Series: Tee Strainer Dimensions | 2" - 30" | ANSI CLASS 150**

**DIMENSIONS AND WEIGHTS<sup>(1)</sup>**

	in	2	2 1/2	3	4	5	6	8	10	12	14	16	18	20	24	30
<b>(A<sub>1</sub>) Face to Face<sup>(2)</sup></b> FT 20, FT 23 - Butt-Weld	mm	50	65	80	100	125	150	200	250	300	355	405	460	508	610	762
	in	5.00	6.00	6.75	8.25	9.75	11.25	14.00	17.00	20.00	22.00	24.00	27.00	30.00	34.00	44.00
<b>(A<sub>2</sub>) Face to Face<sup>(2)</sup></b> FT 21, FT 24 - Flanged	mm	127	152	172	210	248	286	356	432	508	559	610	686	762	864	1118
	in	10.25	11.75	12.50	14.50	17.00	18.50	22.25	25.25	29.25	32.25	34.25	38.25	41.63	46.25	54.50
<b>(B<sub>1</sub>) Ctr-Line to Top<sup>(3)</sup></b> FT 20 - FT 22 - Bolted Cover	mm	130	149	159	184	216	235	283	321	372	410	435	486	529	587	692
	in	5.13	5.88	6.25	7.25	8.50	9.25	11.13	12.63	14.63	16.13	17.13	19.13	20.81	23.13	27.25
<b>(B<sub>2</sub>) Ctr-Line to Top<sup>(3)</sup></b> FT 23 - FT 25 - Quick Open Cover	mm	n/a	n/a	n/a	n/a	n/a	243	294	354	403	446	482	546	608	692	857
	in	n/a	n/a	n/a	n/a	n/a	9.56	11.56	13.94	15.88	17.56	19.00	21.50	23.94	27.25	33.75
<b>C Dimension</b> Screen Removal	mm	291	335	362	426	503	554	675	778	905	997	1073	1200	1311	1480	1765
	in	11.44	13.19	14.25	16.75	19.78	21.81	26.56	30.63	35.63	39.25	42.25	47.25	51.63	58.25	69.50
<b>Approx. Weight: FT 20</b>	lb	18.13	C/F	34.38	56.88	C/F	108.75	178.75	246.25	413.75	523.75	643.75	666.25	1030.00	1532.50	C/F
	kg	8.22	C/F	15.60	25.80	C/F	49.33	81.08	111.70	187.70	237.60	292.00	302.21	467.00	695.13	C/F
<b>Approx. Weight: FT 21</b>	lb	33.13	C/F	63.13	98.13	C/F	173.75	283.75	381.25	633.75	808.75	993.75	1078.75	1522.50	2202.50	C/F
	kg	15.00	C/F	28.63	44.51	C/F	78.81	128.71	172.93	287.50	366.84	450.80	489.31	690.60	999.10	C/F

1. Dimensions and weights of the FT 20 series are provided for reference only. Certified drawings are required for all Titan fabrications.
2. Face to face values have a tolerance of ±0.06 in (±2.0 mm) for sizes 10" and lower and a tolerance of ±0.12 in (±3.0 mm) for sizes 12" and larger.
3. Center line to top dimension is to the top of the body flange. Quick open cover dimension is to the top of body housing.

Titan FCI's fabricated products are made to each customer's unique specifications. Dimensions, materials, and all other product details referenced in this literature are general in nature. Some options may not be available in all sizes and/or models. Titan FCI reserves the right to make design and specification changes to improve the products without prior notification.

**For exact product specifications, please consult the Titan FCI factory and request certified engineering drawings.**